

Uneven Split Quadrature Coupler 5dB

Description:

The X4C55J1-05G is a low cost, low profile (0.59mm) sub-miniature (0805) high performance 5 dB coupler, with a power rating of 5 Watts (AVG) and a peak to average ratio of 12dB, in a new easy to use, Xinger style manufacturing friendly surface mount package. It is designed particularly for 5G (N104), 6G and C-Band applications in all end markets including telecom and COTS Mil-Aero. The X4C55J1-05G is designed particularly for power splitting and combining, where tightly controlled coupling and low insertion loss is required.



Parts have been subjected to rigorous Xinger qualification testing and they are manufactured using materials with coefficients of thermal expansion (CTE) compatible with common substrates such as FR4, RF-35, RO4350 and polyimide. Produced with 6 of 6 RoHS compliant ENIG finish.

Features:

- 5000 to 7200 MHz
- 0.59mm Height Profile
- Power 5W (AVG)
- Peak to Average Ratio of 12dB
- 5G (N104), 6G, C-Band COTS Mil-Aero
- Very Low Loss (<0.5dB)
- High Isolation (>24dB)
- Production Friendly
- Tape and Reel
- Lead Free

Electrical Specifications*:

Frequency	Coupling	Insertion Loss	Return Loss
MHz	dB	dB Max	dB Min
5000-6300	5.0 ± 0.50	0.5	20
6300-7200	5.5 ± 0.75	0.5	18
Isolation	Phase Balance	Power	Operating Temp.
dB Min	degree	Avg. Watts @ 105°C	°C
25	± 4	5	-55 to +140
24	± 6	5	-55 to +140

*Specification based on performance of unit properly installed on TTM Test Board with small signal applied. Specifications subject to change without notice. Refer to parameter definitions for details.

Mechanical Outline:

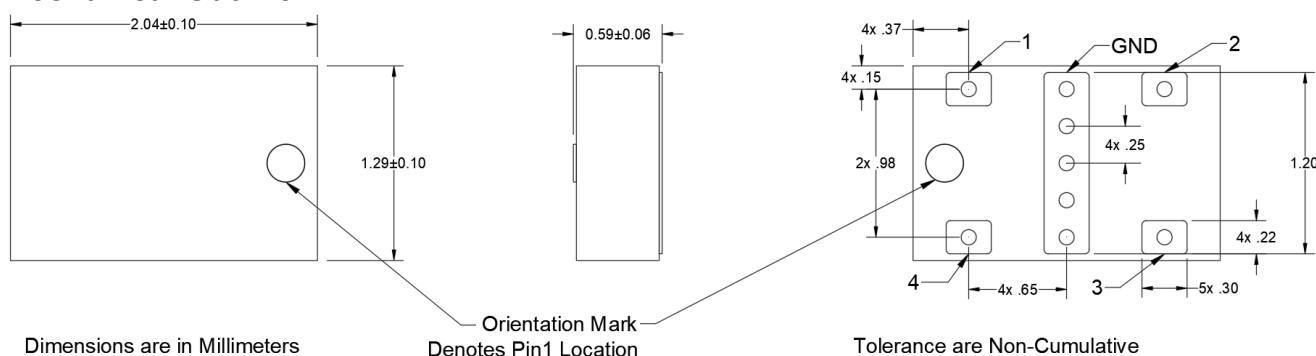

Coupler Pin Configuration:

The X4C55J1-05G has an orientation marker to denote Pin 1. Once port one has been identified, the other ports are known automatically. Please see the chart below for clarification.

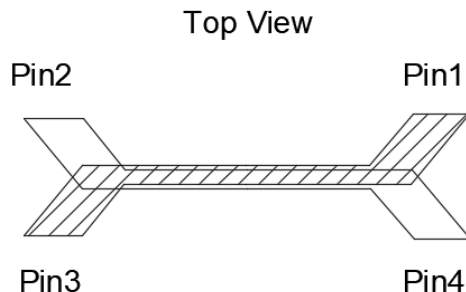

5dB Coupler

Configuration	Pin 1	Pin 2	Pin 3	Pin 4
Splitter	Input	Isolated	$-2\text{dB} < \Theta < -90$	$-5\text{dB} < \Theta$
Splitter	Isolated	Input	$-5\text{dB} < \Theta$	$-2\text{dB} < \Theta < -90$
Splitter	$-2\text{dB} < \Theta < -90$	$-5\text{dB} < \Theta$	Input	Isolated
Splitter	$-5\text{dB} < \Theta$	$-2\text{dB} < \Theta < -90$	Isolated	Input

Note: The direct port has a DC connection to the input port and the coupled port has a DC connection to the isolated port.

Insertion Loss and Power Derating Curves:

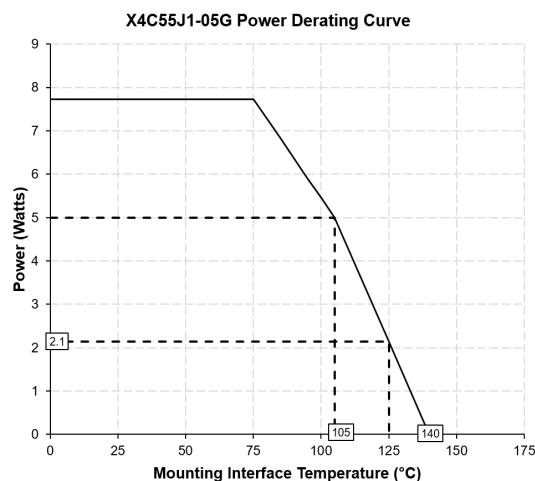
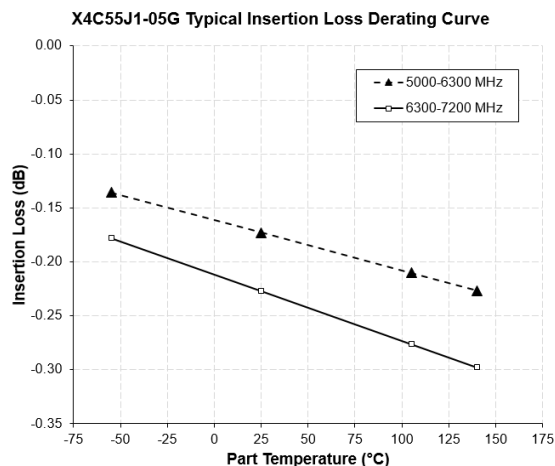

Insertion Loss Derating:

The insertion loss, at a given frequency, of the coupler is measured at 25°C and then averaged. The measurements are performed under small signal conditions (i.e. using a Vector Network Analyzer). The process is repeated at -55°C, 105°C and 140°C. A best-fit line for the measured data is computed and then plotted from -55°C to 140°C.

Power Derating:

The power handling and corresponding power derating plots are a function of the thermal resistance, mounting surface temperature (base plate temperature), maximum continuous operating temperature of the coupler, and the thermal insertion loss. The thermal insertion loss is defined in the Power Handling section of the data sheet.

As the mounting interface temperature approaches the maximum continuous operating temperature, the power handling decreases to zero.

If mounting temperature is greater than 105°C, the Xinger coupler will perform reliably as long as the input power is derated to the curve above.

Typical Performance at:4500-7500 MHz

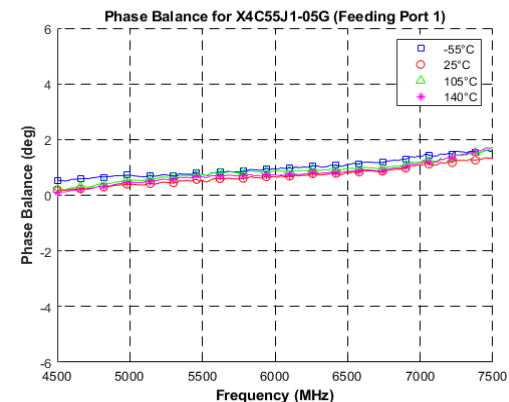
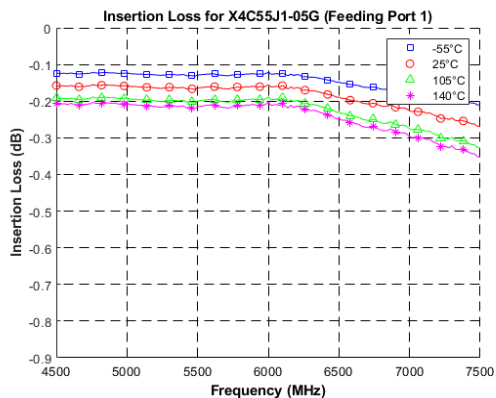
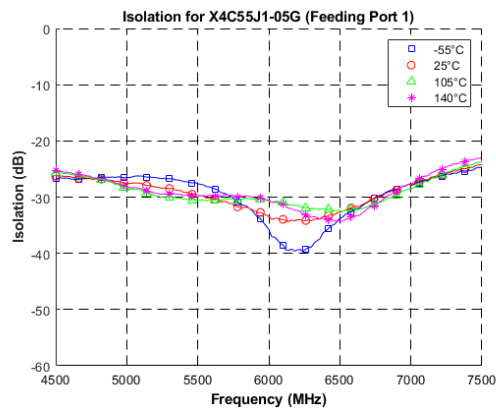
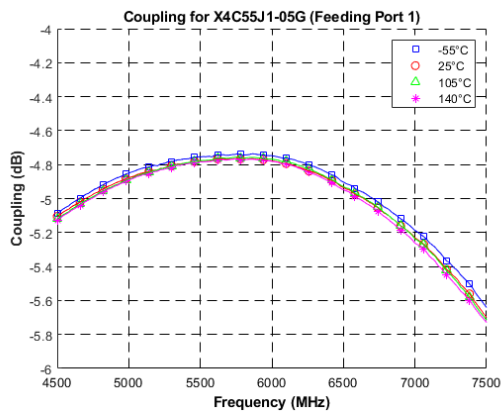
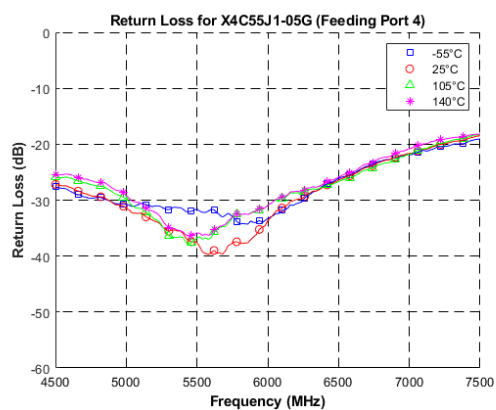
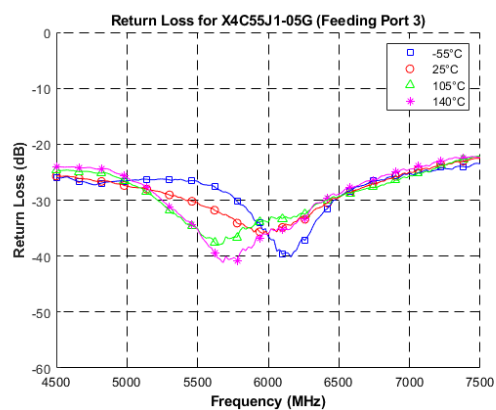
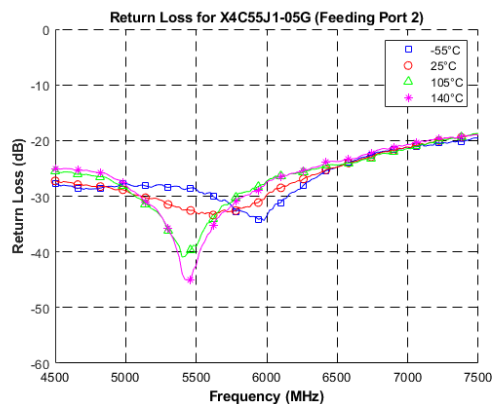
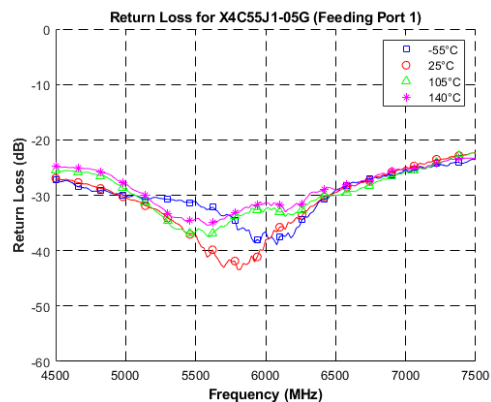

Definition of Measured Specifications:

Parameter	Definition	Mathematical Representation
VSWR (Voltage Standing Wave Ratio)	The impedance match of the coupler to a 50Ω system. A VSWR of 1:1 is optimal.	$VSWR = \frac{V_{max}}{V_{min}}$ Vmax = voltage maxima of a standing wave Vmin = voltage minima of a standing wave
Return Loss	The impedance match of the coupler to a 50Ω system. Return Loss is an alternate means to express VSWR.	$Return\ Loss(dB) = 20\log \frac{VSWR + 1}{VSWR - 1}$
Insertion Loss	The input power divided by the sum of the power at the two output ports.	$Insertion\ Loss(dB) = 10\log \frac{P_{in}}{P_{cpl} + P_{direct}}$
Isolation	The input power divided by the power at the isolated port.	$Isolation(dB) = 10\log \frac{P_{in}}{P_{iso}}$
Phase Balance	The difference in phase angle between the two output ports.	Phase at coupled port - Phase at direct port
Coupling	At a given frequency (ω_n), coupling is the input power divided by the power at the coupled port.	$Coupling(dB) = C(\omega_n) = 10\log \frac{P_{in}(\omega_n)}{P_{cpl}(\omega_n)}$
Group Delay	Group delay is average of group delay's from input port to the coupled port	Average (GD-C)

Peak Power Handling:

High-Pot testing of these couplers during the qualification procedure resulted in a minimum breakdown voltage of 1Kv (minimum recorded value). This voltage level corresponds to a breakdown resistance capable of handling at least 12dB peak over average power levels, for very short durations. The breakdown location consistently occurred across the pads and the ground bar. The breakdown levels at these points will be affected by any contamination in the gap area around these pads. These areas must be kept clean for optimum performance. It is recommended that the user test for voltage breakdown under the maximum operating conditions and over worst case modulation induced power peaking. This evaluation should also include extreme environmental conditions (such as high humidity).

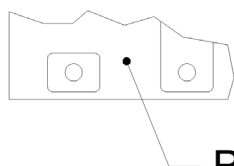

Breakdown Area

Packaging and Ordering Information:

Parts are available in reel and are packaged per EIA 481. Parts are oriented in tape and reel as shown below. Minimum order quantities are 4000 per reel.

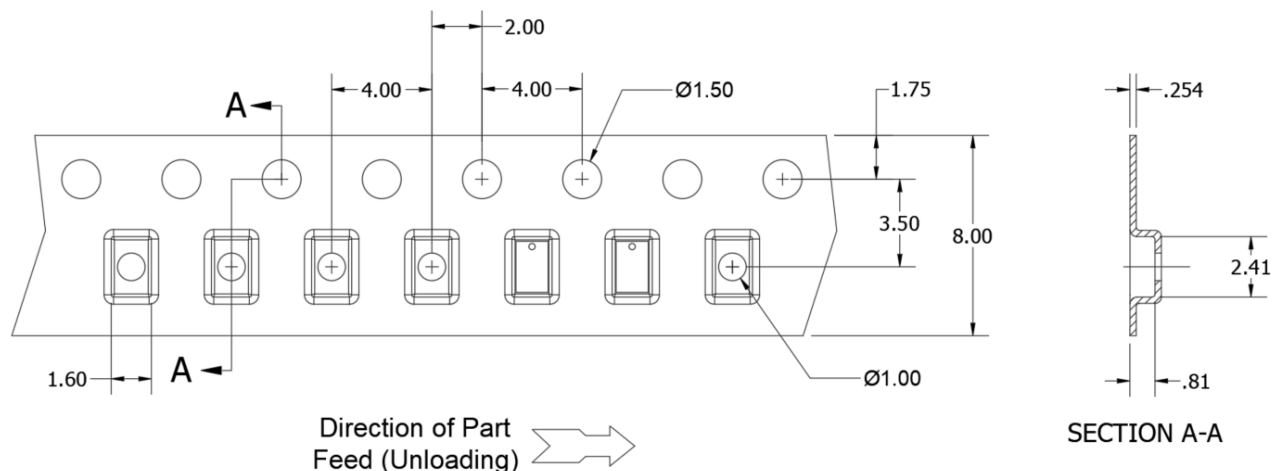

Dimensions are in Millimeters

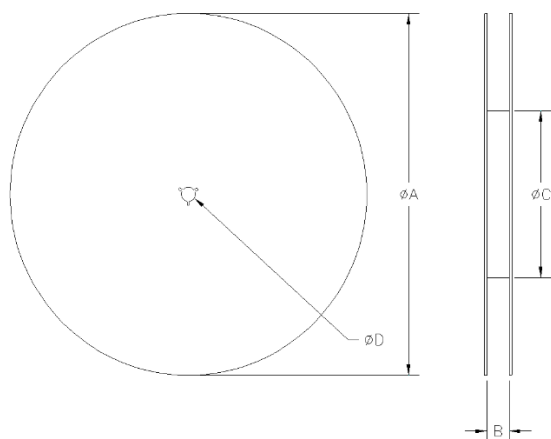

TABLE 1		
QUANTITY/REEL	REEL DIMENSIONS mm	
4000	$\varnothing A$	177.80
	B	8.00
	$\varnothing C$	50.80
	$\varnothing D$	13.00

Contact us:
rf&s_support@ttm.com