

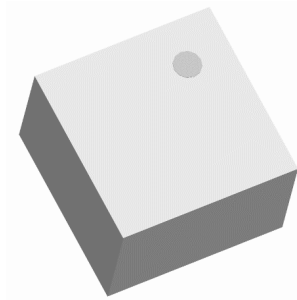

**Ultra-Low Profile 0404 Balun
50Ω to 100Ω Balanced**



Description:

The BD120170N50100AHF is an ultra-small (0404), low profile, balanced to unbalanced transformer in an easy to use Xinger style manufacturing friendly surface mount package. BD120170N50100AHF has a power rating of 1 Watts (AVG) and a peak to average ratio of 12dB. The BD120170N50100AHF is ideal for high volume manufacturing and is higher performance, with improved CTE compatibility to commonly used PCB's than traditional ceramic balun. The BD120170N50100AHF has an unbalanced port impedance of 50Ω and a 100Ω balanced port impedance in the emerging 6G Telecom, P2P and P2MP Radio & COTS Mil- Aero markets.

All parts have been subjected to rigorous Xinger qualification testing and units are 100% RF tested. All of the Xinger components are constructed from ceramic filled PTFE composites which possess excellent electrical and mechanical stability and available on tape and reel for pick and place high volume manufacturing

Features:

- 12.7 – 15.4 GHz
- 0.67mm Height Profile
- 6G Telecom, P2P and P2MP Radio & COTS Mil- Aero markets
- Power 1 Watts (AVG)
- Peak to Average Ratio 12dB
- Low Insertion Loss (<1.5dB)
- Surface Mountable
- Tape & Reel
- RoHS Compliant
- Halogen Free

Electrical Specifications*:

Parameter (@25°C)	Min.	Typ.	Max	Unit
Frequency	12.7		15.4	GHz
Unbalanced Port Impedance		50		Ω
Balanced Port Impedance		100		Ω
Return Loss	12	13.9		dB
Insertion Loss*		0.53	1.5	dB
Amplitude Balance		1.2	2	dB
Phase Balance		2.2	5	Degrees
CMRR		22		dB
Power Handling @85°C			1	Watts
Operating Temperature	-55		+140	°C

*Specifications subject to change without notice.

Outline Drawing:

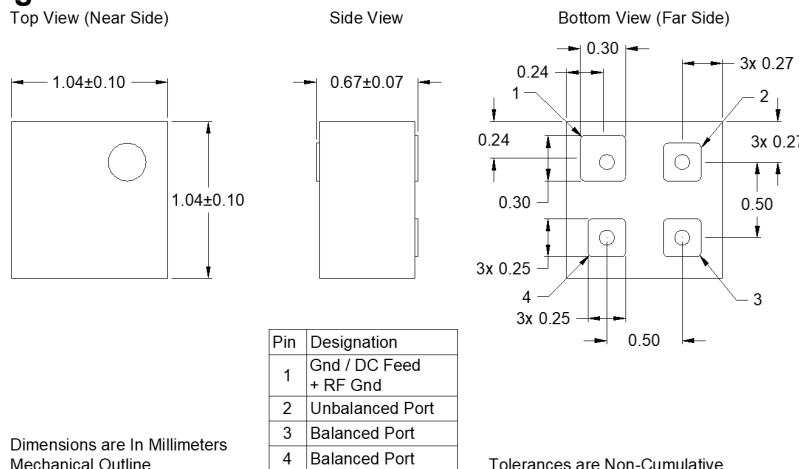

Insertion Loss and Power Derating Curves:

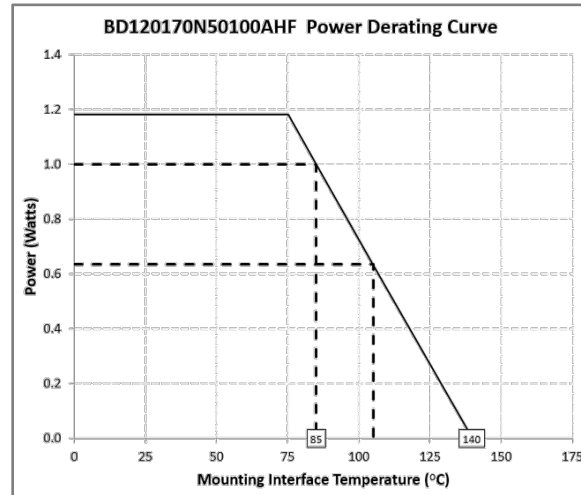
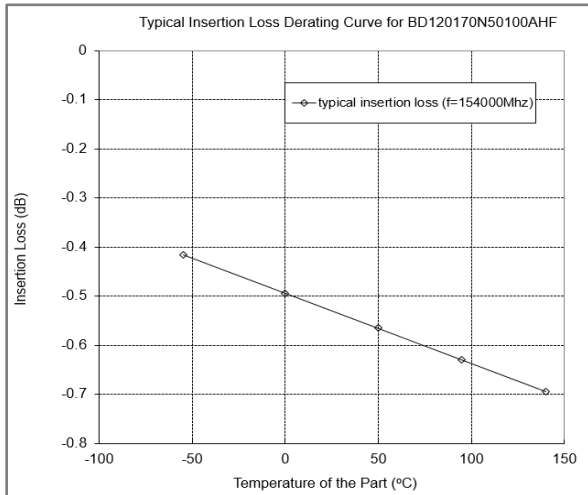

Insertion Loss Derating:

The insertion loss, at a given frequency, of the balun is measured at 25°C and then averaged. The measurements are performed under small signal conditions (i.e. using a Vector Network Analyzer). The process is repeated at temperatures from -55 to 140°C. A best-fit line for the measured data is computed and then plotted from -55°C to 140°C.

Power Derating:

The power handling and corresponding power derating plots are a function of the thermal resistance, mounting surface temperature (base plate temperature), maximum continuous operating temperature of the balun, and the thermal insertion loss. The thermal insertion loss is defined in the Power Handling section of the data sheet.

As the mounting interface temperature approaches the maximum continuous operating temperature, the power handling decreases to zero.

If mounting temperature is greater than 85°C, the Xinger balun will perform reliably as long as the input power is derated to the curve above.

Wide Band Performance: 12.7 GHz to 15.4 GHz

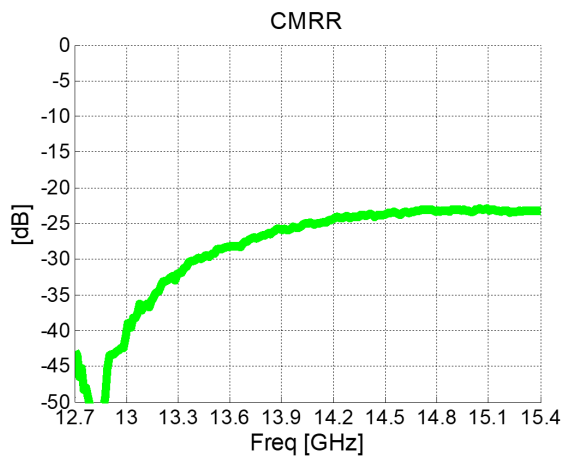
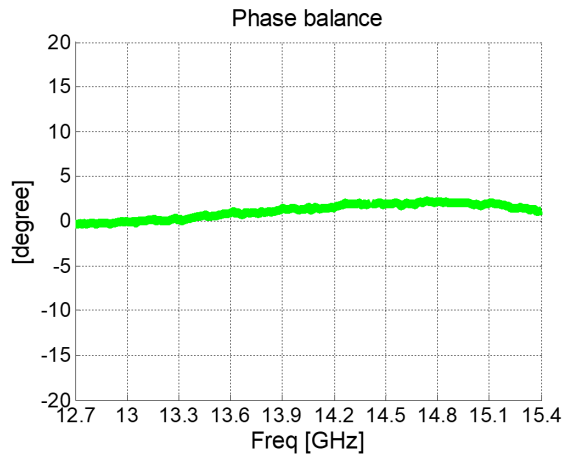
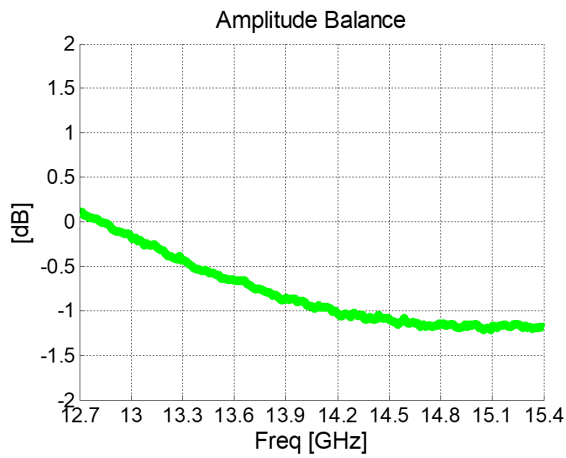
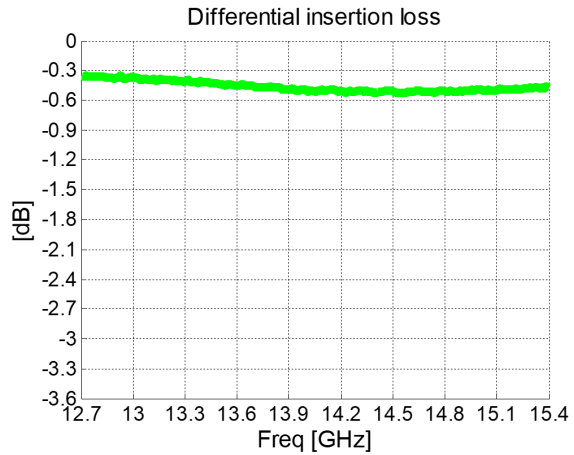
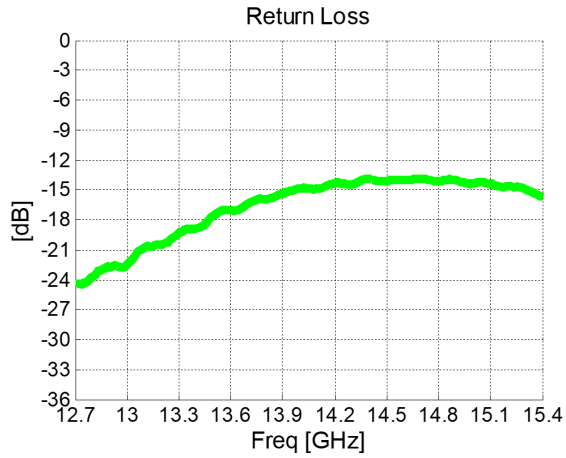

Definition of Measured Specifications:

Parameter	Definition	Mathematical Representation
Return Loss	The impedance match at the single ended port.	$RL = 20Log_{10}(S_{11})$
Differential Port Return Loss	The impedance match at the differential port.	$RLD = 20Log_{10} 0.5 * (S_{22} - S_{23} - S_{32} + S_{33}) $
Insertion Loss	Power loss from common mode to differential mode.	$ILD = 20Log_{10}(0.707 * (S_{21} - S_{31}))$
Phase Imbalance	The difference in phase angle between the two differential ports, offset by 180 deg.	$PB = (Phase(S_{21}) - Phase(S_{31})) - 180^\circ$
Amplitude Imbalance	The ratio of the power at differential ports.	$AB = 20Log_{10} \frac{S_{21}}{S_{31}} $
Common Mode Rejection Ratio	The ratio of powers of the differential gain to the common-mode gain.	$CMRR = \pm 20Log_{10}(S_{21}+S_{31})/(S_{21}-S_{31})$

*Parts are 100% RF tested as per spec definition. Refer to page 1 for pin assignment

Peak Power Handling:

High-Pot testing of these components during the qualification procedure resulted in a minimum breakdown voltage of 1Kv (minimum recorded value). This voltage level corresponds to a breakdown resistance capable of handling at least 12dB peak over average power levels, for very short durations. The breakdown location consistently occurred across the pads and the ground pads. The breakdown levels at these points will be affected by any contamination in the gap area around these pads. These areas must be kept clean for optimum performance. It is recommended that the user test for voltage breakdown under the maximum operating conditions and over worst case modulation induced power peaking. This evaluation should also include extreme environmental conditions (such as high humidity).

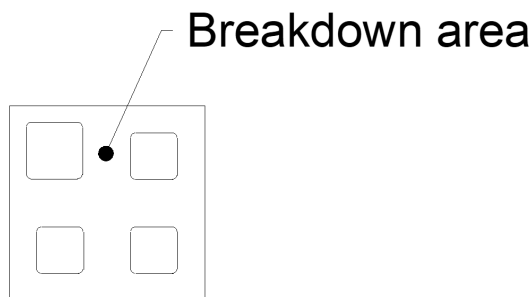

Packaging and Ordering Information:

Parts are available in reel and are packaged per EIA 481. Parts are oriented in tape and reel as shown below. Minimum order quantities are 4000 per reel.

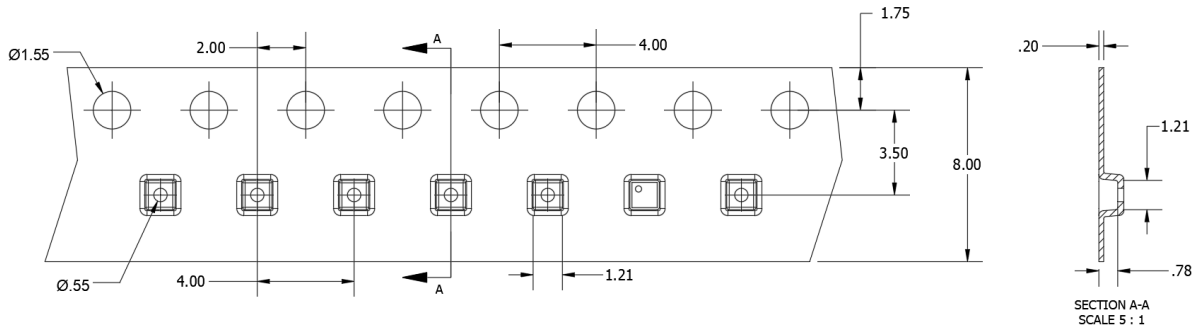

Dimensions are in Millimeters

➔ Direction of Part Feed (Unloading)

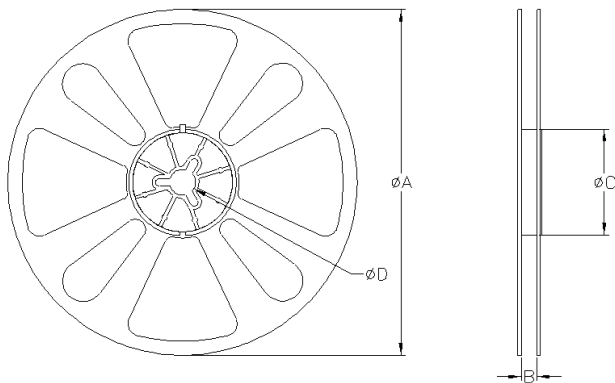

TABLE 1		
QUANTITY/REEL	REEL DIMENSIONS mm	
4000	ØA	177.80
	B	8.00
	ØC	50.80
	ØD	13.00

Contact us:
rf&s_support@ttm.com